

MK-1080 PAVER SAW OPERATION & PARTS MANUAL

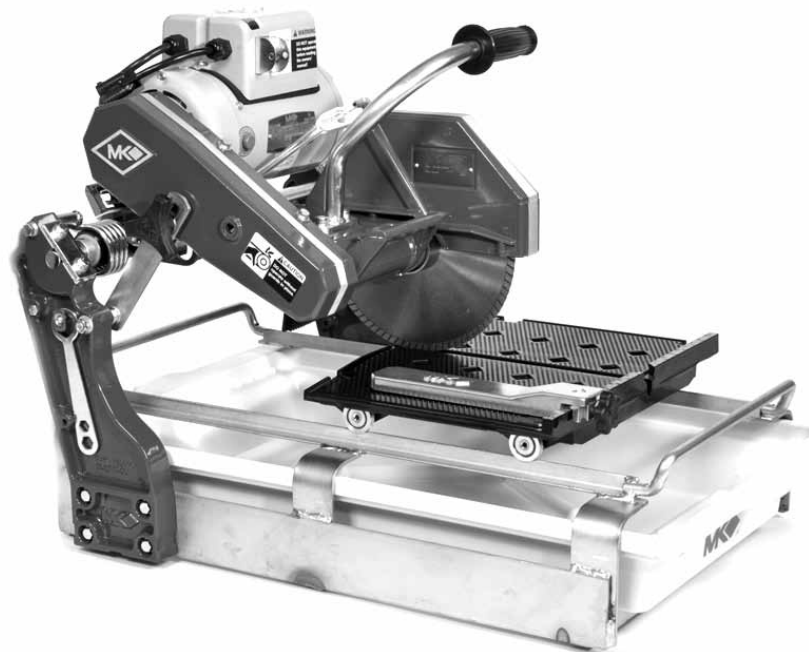

Revision 102	03.2012
Manual Part No. 166894	

Caution: Read all safety and operating instructions before using this equipment. This manual **MUST** accompany the equipment at all times.

INTRODUCTION

Congratulations on your purchase of a MK-1080 Paver Saw. We are certain that you will be pleased with your purchase. MK Diamond takes pride in producing the finest construction power tools and diamond blades in the industry.

Operated correctly, your MK-1080 Paver Saw should provide you with years of service. In order to help you, we have included this manual. This owners manual contains information necessary to operate and maintain your MK-1080 Paver Saw safely and correctly. Please take a few minutes to familiarize yourself with the MK-1080 Paver Saw by reading and reviewing this manual.

If you should have questions concerning your MK-1080 Paver Saw, please feel free to call our friendly customer service department at: 800 421-5830

Regards,

MK Diamond

NOTE THIS INFORMATION FOR FUTURE USE:

MODEL NUMBER:	
SERIAL NUMBER:	
PURCHASE PLACE:	
PURCHASE DATE:	

NOTE: For your (1) one year warranty to be effective, complete the warranty card (including the Serial Number) and mail it in as soon as possible.

TABLE OF CONTENTS

SAFETY

Safety Message/Alert Symbols	4
Safety Warnings	5
Hazard Symbols	6
Rules for Safe Operation	7-8
Electric Motor Safety	9
Electrical Requirements & Grounding Instructions	10-11
Operation & Safety Decals	12
Safety Decal Locations	13

PRODUCT SPECIFICATIONS

Specifications	14
----------------	----

INSPECTION & SET-UP

Unpacking & Contents	15
Installing the Blade	16-17
Installing the Water Pump	18

OPERATION

Motor Information	19
Cutting Operations	20

MAINTENANCE

Adjusting Belt Tension	21-22
Adjusting Blade Alignment to Table	23
Diamond Blade Sharpening (Re-Dressing)	23

GENERAL PRODUCT INFORMATION

Parts List: Paver Saw, MK-1080 1.5 HP 120V 60HZ, 153203	24-25
Parts List: Paver Saw, MK-1080 Home Depot 1.5 HP 120V 60HZ, 153203-HD	26-27
Parts List: Paver Saw, MK-1080 Assy, Cutting Head, 166877	28-29
Parts List: Paver Saw, MK-1080 Home Depot Assy, Cutting Head, 166877-HD	30-31
Parts List: Paver Saw, MK-1080 Assy, Motor Mount, 166878	32-33
Parts List: Paver Saw, MK-1080 Home Depot Assy, Motor Mount, 166878-HD	34-35
Parts List: Paver Saw, MK-1080 Assy, Table, 166880	36
Parts List: Paver Saw, MK-1080 Assy, Blade Guard, 154297	37
Parts List: Paver Saw, MK-1080 Home Depot Assy, Blade Guard, 154297-HD	38
Parts List: Paver Saw, MK-1080 Assy, Spring Bushing, 166874	39
Ordering Information	42
Contact Information and Limited Warranty	43

Safety precautions should be followed at all times when operating this equipment. Failure to read and understand the Safety Precaution and Operating Instructions could result in injury to yourself and others. This Operation and Parts Manual has been developed to provide complete instructions for the safe and efficient operation of the MK-1080 Paver Saw.

Before using this machine, ensure that the person operating the machine has read and understands all instructions in this manual.

SAFETY MESSAGE / ALERT SYMBOLS

A safety message alerts you to potential hazards that could hurt you or others. Each safety message is preceded by a safety alert symbol () and one of three words: **DANGER**, **WARNING**, or **CAUTION**.



DANGER

You **WILL** be **KILLED** or **SERIOUSLY INJURED** if you do not follow directions.



WARNING

You **CAN** be **KILLED** or **SERIOUSLY INJURED** if you do not follow directions.



CAUTION

You **CAN** be **INJURED** if you do not follow directions. It may also be used to alert against unsafe practices.

Each message tells you what the hazard is, what can happen, and what you can do to avoid or reduce injury. Other important messages are preceded by the word **NOTICE**.



NOTICE

You can cause **PROPERTY DAMAGE** to your machine if you don't follow directions.

The safety labels should be periodically inspected and cleaned by the user to maintain good legibility at a safe viewing distance. If the label is worn, damaged or illegible, it should be replaced.

Potential hazards associated with the MK-1080 Paver Saw operation will be referenced with Hazard Symbols which appear throughout this manual, and will be referenced in conjunction with Safety Message/Alert Symbols.

HAZARD SYMBOLS



ALWAYS read this Owner's Manual before operating the machine.



ALWAYS avoid inhalation of and skin contact with silica dust and/or mist.



ALWAYS place the power ON/OFF switch in the **OFF** position when the machine is not in use.



ALWAYS wear approved eye protection.



ALWAYS wear approved respiratory protection.



NEVER operate equipment with covers, or guards removed. Keep fingers, hands, hair and clothing away from all moving parts to prevent injury.



ALWAYS use caution around gears. Keep fingers, hands, hair and clothing away from all moving parts to prevent injury.



NEVER touch the power cord with wet hands or while standing in water when it is connected to a power source.



NEVER operate the machine in an explosive atmosphere or near combustible materials.

RULES FOR SAFE OPERATION



DANGER

Failure to follow instructions in this manual may lead to serious injury or even death! This equipment is to be operated by trained and qualified personnel only! This equipment is for industrial use only.

The following safety guidelines should always be used when operating the MK-1080 Paver Saw.

GENERAL SAFETY



- **DO NOT** operate or service this equipment before reading this entire manual.

- This equipment should not be operated by persons under 18 years of age.
- **NEVER** operate this equipment without proper protective clothing, shatterproof glasses, steeltoed boots and other protective devices required by the job.
- **NEVER** operate this equipment when not feeling well due to fatigue, illness or taking medicine.
- **NEVER** operate this equipment under the influence of drugs or alcohol.
- Whenever necessary, replace nameplate, operation and safety decals when they become difficult to read.
- **ALWAYS** check the machine for loose bolts before starting.



- **ALWAYS** wear proper respiratory (mask) hearing and eye protection equipment when operating this machine.

- **ALWAYS** store equipment properly when it is not being used. Equipment should be stored in a clean, dry location out of the reach of children.



- **NEVER** leave the machine unattended. Turn off electric motor when unattended.

- **CAUTION** must be observed while servicing the machine. Rotating parts can cause injury if contacted.
- Ensure that any electrical extension cord is protected against damage. Always ensure that the electrical extension cord is not trapped underneath the machine. When using an extension cord, be sure to use one heavy enough to carry the current your product will draw. An undersized cord will cause a drop in line voltage that will result in a loss of power and overheating. The Table shown on page 11 shows the correct AWG size to use depending on cord length and nameplate ampere rating. If in doubt, use the next heaviest gage. The smaller the gage number, the heavier the cord.



- **DO NOT** allow extension cord to come into contact with water or fluids.
- **DO NOT** spray water onto electric motor.
- **NEVER** operate the machine in an explosive atmosphere.

- Before starting the machine, check that all guards are in position and correctly fitted.
- Keep area around the machine clear of obstructions which could cause persons to fall onto moving parts.
- **ALWAYS** ensure that the machine is on level ground before using.
- **DO NOT** overreach. Keep proper footing and balance at all times.

- **NEVER** stand on the tool. Serious injury could occur if a power tool is tipped, or if a cutting tool is unintentionally contacted.
- Become familiar with the controls of the machine before operating. Know how to stop the machine quickly in case of emergency.
- **ALWAYS** secure work. Clamps or a vise should be used to hold work whenever practical. Keeping your hands free to operate a power tool is safer.
- **ALWAYS** disconnect AC power plug from power source before moving, cleaning or servicing the machine.
- **NEVER** leave a tool running unattended. Do not leave a tool until it comes to a complete stop. **ALWAYS** turn a power tool **OFF** when leaving the work area, or when a cut is finished.
- Make sure the OFF/ON power switch on the electric motor is always in the **OFF** position before inserting the machine's power plug into an AC receptacle.
- Operate electric motor only at the specified voltage indicated on the nameplate.
- **NEVER** disconnect any "emergency or safety devices". These devices are intended for operator safety. Disconnection of these devices can cause severe injury, bodily harm or even death! Disconnection of any of these devices will void all warranties.
- Unauthorized equipment modifications will void all warranties. Manufacturer does not assume responsibility for any accident due to equipment modifications.
- **NEVER** use accessories or attachments, which are not recommended by MK Diamond for this equipment. Damage to the equipment and/or injury to user may result.
- Replace damaged cutting blade before operating.
- **NEVER** try to stop a moving blade with your hand.

**WARNING**

NEVER use this machine with any cutter designed for wood working.

MAINTENANCE SAFETY

- **NEVER** lubricate components or attempt service on a running machine.
- Keep the machinery in proper running condition.
- Before using a power tool, check for damaged parts. A guard or any other part that is damaged should be carefully checked to determine if it would operate properly and perform its intended function. Always check moving parts for proper alignment or binding. Check for broken parts and mountings and all other conditions that may affect the operation of the power tool. A guard, or any damaged part, should be properly repaired or replaced.

SAW SAFETY

**WARNING**

- Wear eye protection.
- Disconnect saw before servicing, when changing cutting blades and cleaning.
- Replace damaged cutting blade before operation.
- Remove adjusting keys and wrenches.

SILICA DUST WARNING

Grinding/cutting/drilling of masonry, concrete, metal and other materials with silica in their composition may give off dust or mists containing crystalline silica. Silica is a basic component of sand, quartz, brick clay, granite and numerous other minerals and rocks. Repeated and/or substantial inhalation of airborne crystalline silica can cause serious or fatal respiratory diseases, including silicosis. In addition, California and some other authorities have listed respirable crystalline silica as a substance known to cause cancer. When cutting such materials, always follow respiratory precautions.

CALIFORNIA PROPOSITION 65 MESSAGE

Some dust created by power sanding, sawing, grinding, drilling, and other construction activities contain chemicals known (to the State of California) to cause cancer, birth defects or other reproductive harm. Some examples of these chemicals are:

- Lead, from lead-based paints
- Crystalline silica, from bricks and cement and other masonry products
- Arsenic and chromium, from chemically treated lumber

For further information, consult the following sources:

<http://www.osha.gov/dsg/topics/silicacrystalline/index.html>

<http://www.cdc.gov/niosh/consilic.html>

<http://oehha.ca.gov/prop65/law/P65law72003.html>

<http://www.dir.ca.gov/Title8/sub4.html>

Your risk from these exposures varies depending on how often you do this type of work. To reduce your exposure to these chemicals, work in a well-ventilated area, and work with approved safety equipment, such as those dust masks that are specially designed to filter out microscopic particles.

ELECTRIC MOTOR SAFETY

For maintenance care and operation of the electric motor, refer to your electric motor instruction booklet furnished with the electric motor. Protect the electric motor from dust as much as possible and keep ventilating openings clean.

**CAUTION**

- **DO NOT** spray water on the electric motor. Do not touch the plug with wet hands. To reduce the risk of electrocution, keep all connections dry and off the ground.
- **DO NOT** operate electric motor in an explosive environment.

**WARNING**

Use only extension cords that are intended for outdoor use. These extension cords are identified by a marking, "Acceptable for use with outdoor appliances; store indoors while not in use." Use only extension cords having an electrical rating not less than the rating of the product. Do not use damaged extension cords. Examine extension cords before using and replace if damaged. Do not abuse extension cords and do not yank on any cord to disconnect. Always disconnect the extension cord from the receptacle before disconnecting the product from the extension cord.

Electric Motor Connection

ALWAYS make certain that the power source required for the electric motor is correct and always use the correct NEMA configuration plug. Motors can burn out when the line voltage falls 10% below the voltage rating of the motor. Failure to use proper voltage will cause the motor to overheat. Make certain that the correct size grounded (3-wires) extension cord is used. See the table below.

To choose the proper extension cord:

- Locate the length of extension cord needed in table to the right.
- Once the proper length is found, move down the column to obtain the correct AWG size required for that length of extension cord.

NOTICE

Most Motor Problems are caused by improper voltage and extension cords. Cord should be one-piece and short as possible. Cord selection should match the following table.

1-2 H.P.			
<u>115v</u>		<u>230v</u>	
25'	100'	Max. Cord Length	No. 12 Wire
50'	150'	Max. Cord Length	No. 10 Wire
75'	250'	Max. Cord Length	No. 8 Wire

Fig. 1 Extension Cord Table

**WARNING**

Use of undersize extension cords result in low voltage to the motor that can result in motor burnout and premature failure. MK Diamond warns that equipment returned to us showing signs of being run in a low voltage condition, through the use of undersized extension cords will be repaired or replaced totally at the customers expense. There will be no warranty claim.

ELECTRICAL REQUIREMENTS AND GROUNDING INSTRUCTIONS

In order to prevent potential electrical shock and injury, the following electrical safety precautions and symbols should be followed at all times!

WARNING

In case of a malfunction or breakdown, grounding provides a path of least resistance for electric current to reduce the risk of electric shock. This tool is equipped with an electric cord having an equipment-grounding conductor and a grounding plug. The plug must be plugged into a matching outlet that is properly installed and grounded in accordance with all local codes and ordinances.

- Do not modify the plug provided – if it will not fit the outlet; have the proper outlet installed by a qualified electrician
- Improper connections of the equipment-grounding conductor can result in a risk of electric shock. The equipment-grounding conductor is the insulated conductor that has an outer surface that is green, with or without yellow stripes. If repair or replacement of the electric cord or plug is necessary, do not connect the equipment-grounding conductor to a live terminal
- Check with a qualified electrician or service personnel if the grounding instructions are not completely understood, or if in doubt as to whether the tool is properly grounded
- Use only 3-wire extension cords that have 3-prong grounding plugs and 3-pole receptacles that accept the tool's plug
- Repair or replace a damaged or worn cord immediately

WARNING

This tool is intended for use on a circuit that has an outlet that looks like the one shown in Sketch A of Figure 1. The tool has a grounding plug that looks like the plug illustrated in Sketch A of Figure 1. A temporary adapter, which looks like the adapter illustrated in sketches B and C, may be used to connect this plug to a 2-pole receptacle as shown in Sketch B, if a properly grounded outlet is not available. The temporary adapter should be used only until a properly grounded outlet can be installed by a qualified electrician. The green-colored rigid ear, lug, and the like, extending from the adapter, must be connected to a permanent ground such as a properly grounded outlet box.

NOTE: Use of a temporary adapter is not permitted in Canada.

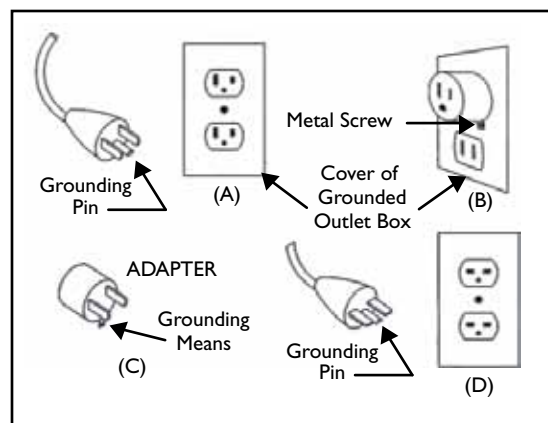

Fig. 1 Circuit and Adapter Information

! WARNING

To reduce the risk of electrocution, keep all connections dry and off the ground. A Ground Fault Circuit Interrupter (GFCI) should be provided on the circuit(s) or outlet(s) to be used for this machine. Receptacles are available having built-in GFCI protections and may be used for this measure of safety. When using an extension cord, the GFCI should be installed closest to the power source, followed by the extension cord and lastly, the machine.

! WARNING

The pump requires a GFCI. To reduce risk of electric shock when operating the machine with the pump plugged into the 3-pole receptacle on the motor, connect the saw to a GFCI outlet. See the pump manual and informational tags enclosed separately for all pump information.

! CAUTION

Shock Hazard. For replacement, use only an identical pump.

NOTE: Do not run pump dry. Also, be sure to disconnect and remove the pump when cutting dry.

! WARNING

To avoid the possibility of the appliance plug or receptacle getting wet, position the machine to one side of a wall mounted receptacle. This will prevent water from dripping onto the receptacle or plug. A “drip loop,” shown in Figure 2, should be arranged by the user to properly position the power cord relative to the power source.

The “drip loop” is that part of the cord below the level of the receptacle, or the connector, if an extension cord is used. This method of positioning the cord prevents the travel of water along the power cord and coming in contact with the receptacle. If the plug or receptacle gets wet, **DO NOT** unplug the cord. Disconnect the fuse or circuit breaker that supplies power to the tool. Then unplug and examine for presence of water in the receptacle.

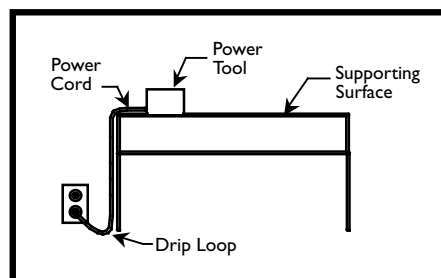
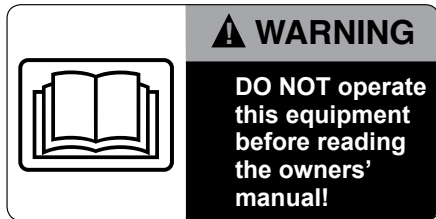

Fig. 2 Drip Loop Information

OPERATION & SAFETY DECALS

The MK-1080 Paver Saw is equipped with a number of safety decals. These decals are provided for operator safety and maintenance information. The photo on the next page also shows the location of these decals. Should any of these operation or safety decals become unreadable, replacements can be obtained by calling **(800) 262-1575**.



Decal A

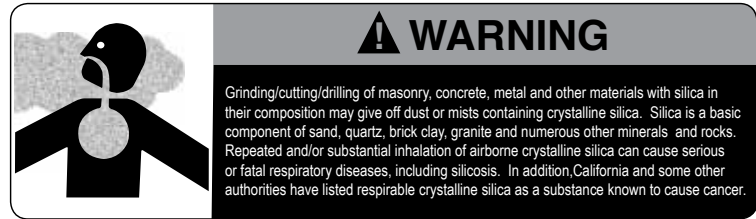

Decal B

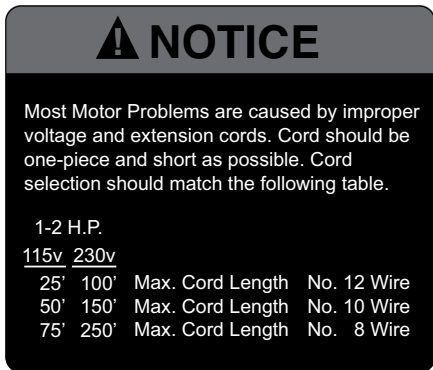

Decal C



Decal D



Decal F



Decal E

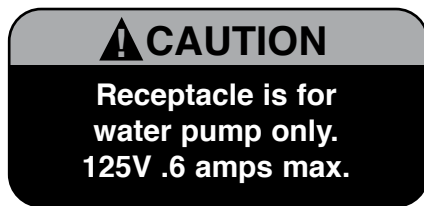

Decal G

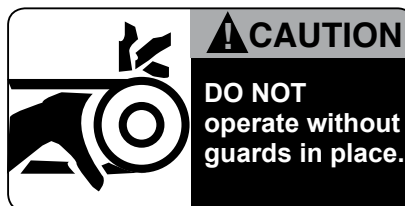

Decal H



Decal I

Figure 4. MK-1080 Paver Saw Safety Decal Sheet, Part No. 166011

SAFETY DECAL LOCATIONS

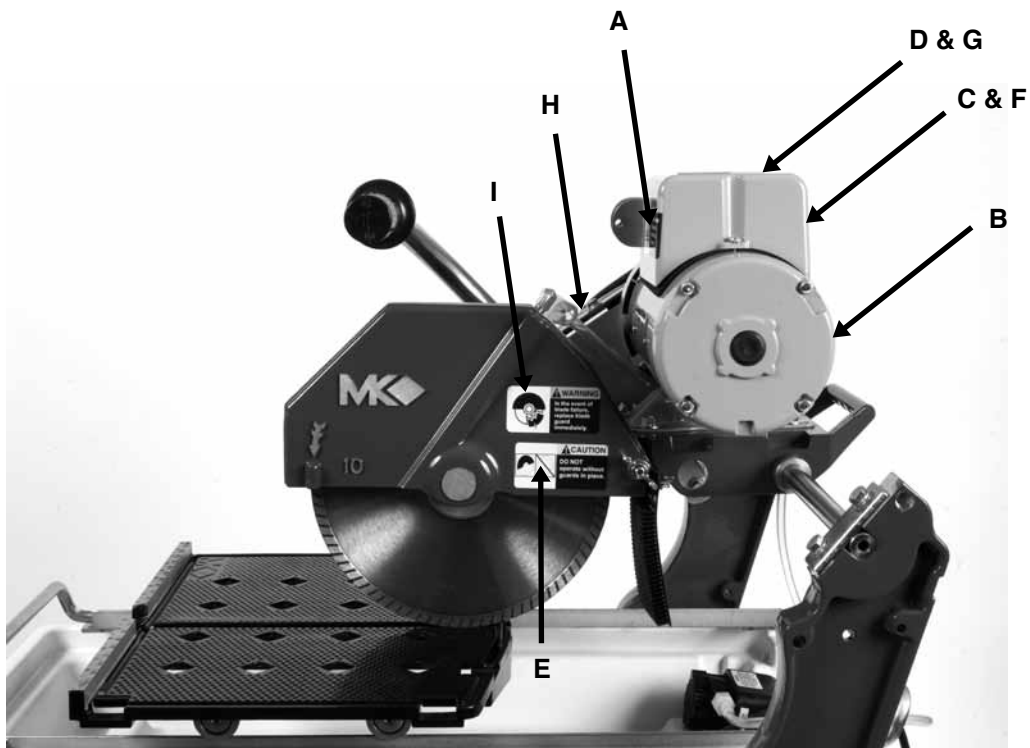

Fig. 5 MK-1080 Paver Saw Safety Decal Locations

Decal	Location	Description
A	Capacitor Box/Front	Read Owners Manual
B	Electric Motor/Back	Proposition 65, Dust Warning
C	Capacitor Box/Back	Voltage & Cord Notice
D	Capacitor Box/Top	Ground Warning (GFCI)
E	Blade Guard/Front	Blade Guard Failure
F	Capacitor Box /Back	Service Information
G	Capacitor Box/Top	Water Pump Attachment
H	Belt Guard/Front	Guards in Place
I	Blade Guard/Front	Replace Blade Guard

MK-1080 Paver Saw Specifications		
Model	153203	153591
Motor	Single Phase 120V / 60 Hz	Single Phase 220V / 50 Hz
Amps	12.4 AMP	6.8 AMP
Horsepower	1-1/2 HP	1-1/2 HP
Motor Overload	Thermal Overload Reset	Thermal Overload Reset
Motor Fan	Enclosed Fan Cooled	Enclosed Fan Cooled
Blade RPM	3,450 RPM	2,850 RPM
Blade Capacity	10" (254 mm)	10" (254 mm)
Arbor Size	5/8" (16 mm)	5/8" (16 mm)
Standard Length of Cut	16" (406 mm)	16" (406 mm)
Maximum Depth of Cut	3-3/4" (95 mm)	3-3/4" (95 mm)
Water Pump Protection	Thermally Protected	Thermally Protected
Water Pump Submersion	Fully Submersible	Fully Submersible
Water Pump Lubrication	Self-Lubricating	Self-Lubricating
Water Pump Capacity	170 gallons/hour (644 litres/hour)	245 gallons/hour (927 litres/hour)
Conveyor Cart Dimensions-(LxW) - inches/cm	12-1/2" x 17" 318 x 432 mm	12-1/2" x 17" 318 x 432 mm
Paver Saw Weight	103 lbs. (46.7 kg)	103 lbs. (46.7 kg)
Saw Dimensions (LxWxH) - inches/mm	33" x 23" x 23" 838 x 584 x 584 mm	33" x 23" x 23" 838 x 584 x 584 mm

- High torque, thermally protected 1-1/2 HP motor
- Recoil spring counterbalanced cutting head
- Cutting table travels on steel roller wheels
- Heavy-duty blade shaft assembly with dual-sealed bearings & precision machined shaft
- Single piece reinforced zinc-plated steel frame has carrying handles for easy transportation
- Hinged blade guard with stainless steel water tubing
- Industrial water pump included
- One-year limited warranty

UNPACKING

Your MK-1080 Paver Saw has been inventoried and packaged with the greatest of care. Inspect the contents of carton against the contents list below. Ensure that all items are accounted for and that they are in sound condition. If there are any missing or damaged parts, call MK Diamond Customer Service at (800) 262-1575 for instructions before proceeding.

CONTENTS

Remove the MK-1080 Paver Saw from the carton and place it on a flat surface. Check contents with list below:

In your container, you will find one (1) MK-1080 and water basin, one (1) splash guard, one (1) water pump, one (1) water pump manual, one (1) rip guide, one (1) blade nut wrench, one (1) owner's manual, one (1) warranty card.

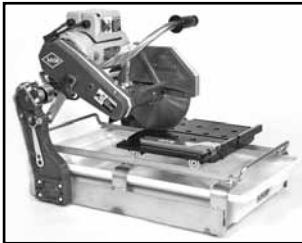

MK-1080 Paver Saw



Splash Guard



Water Pump



Rip Guide

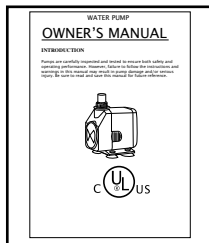

Water Pump Manual



Blade Nut Wrench



Owner's Manual



Warranty Card

ASSEMBLY

Your MK-1080 has been shipped from the factory thoroughly inspected. Only minimal assembly is required.



CAUTION Use proper lifting techniques when lifting the MK-1080.



NOTICE

Before using the machine, check for any broken, worn or damaged parts and replace them immediately.

- **ALWAYS** keep the machine clean and lubricated.
- **ALWAYS** unwind the power supply cord completely and check for damage.
- Carefully check the "Technical Data" Label before plugging in the machine. Follow the extension cord requirements, as recommended on the machine label. Work on a level and clean surface.

CONVEYOR CART

1. The Conveyor Cart is secured for shipping by plastic ties. Remove these plastic ties before use.
2. Ensure that the Cart runs smoothly along the tracks of the Inner Frame.

INSTALLING THE BLADE

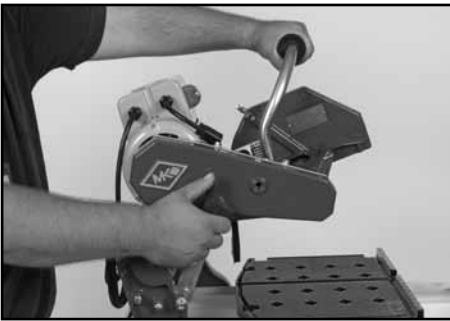

(A)

While holding the cutting head handle down to counteract spring tension, loosen the cutting head lock screw and allow the cutting head to gently rise to its highest point.

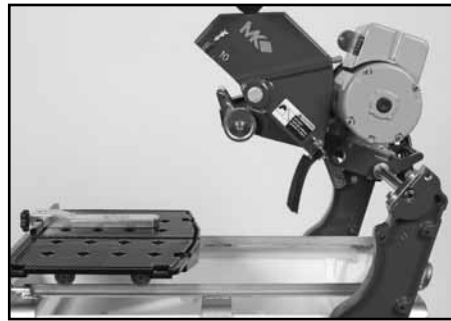

(B)

Slide the cutting table to the front of the saw and raise the blade guard.

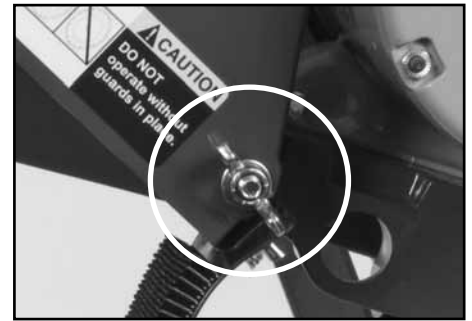

(C)

It may be necessary to adjust the tightness of the blade guard wing nut. When properly tightened, the blade guard will move relatively easily and also stay in the raised position.

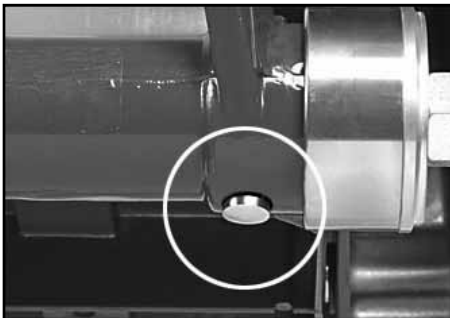

(D)

Locate the shaft lock push button on the underside of the cutting head.

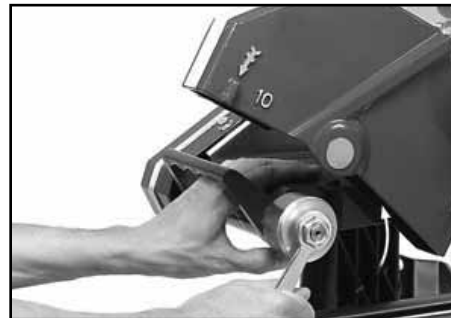

(E)

Depress the shaft lock push button and rotate the arbor shaft till the button locks the arbor shaft in position. If necessary, use the blade wrench to turn the retaining nut counterclockwise to loosen from the arbor shaft.



(F)

Remove the nut and slide the outer flange (l) from the arbor shaft.

INSTALLING THE BLADE

(G)

Install the diamond blade onto arbor shaft.

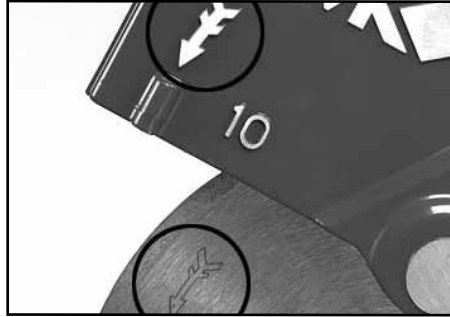

(H)

The direction of rotation arrow on the blade matching the direction of the arrow on the blade guard.

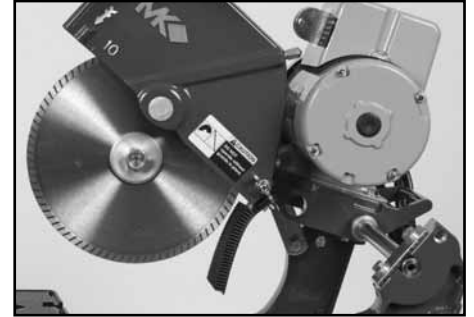

(I)

Verify that the blade is seated flat against the inner flange of the blade shaft.



(J)

Slide the outer flange back on the arbor shaft with the recessed side of the flange facing the blade.

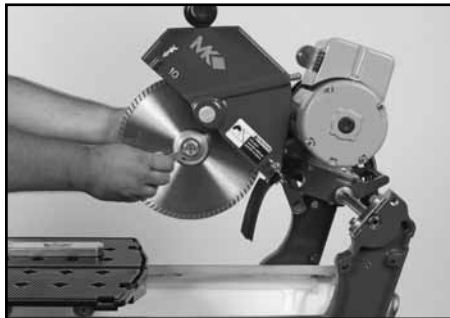

(K)

Install the retaining nut on the arbor shaft. Depress the shaft lock button and use the blade wrench to tighten the retaining nut in a clockwise direction.



(L)

When installing the retaining nut, do not "cross-thread" and do not over tighten. Lower the blade guard back down into the cutting position.

INSTALLING THE WATER PUMP**! WARNING**

To prevent the possibility of electrical shock, the MK-1080 must be unplugged when connecting the Water Pump.



(A)

Install Plastic Fitting onto Water Pump.



(B)

Install Plastic Hose onto Plastic Water Pump Fitting.



(C)

Place Water Pump in pan.



(D)

Route Water Hose through Cushion Loop and under Motor between Fan Guard and Belt Guard.



(E)

Place Clamp on Hose.



(F)

Attach Hose to Blade Guard.

WATER PUMP SYSTEM INFORMATION**! NOTICE**

You may wish to immerse your water pump in a drum of fresh water, as to allow clean/unslurried water to cool the Diamond Blade. This action will keep your machine cleaner and allow the greatest life for your Diamond Blade.

The Electric Water Pump is a powerful, thermally protected, self-lubricating, fully submersible unit capable of delivering 170 gallons (644 litres) of water per hour. For operator convenience, the pump power cord plugs into the female receptacle of the motor terminal box, and is automatically activated as soon as the motor is turned to the "ON" position.

The pump has been designed to operate "WET", therefore it is advisable to disconnect the pump if the operation calls for "DRY" cutting. When running wet, the pump should be kept in the water reservoir in a position that permits the scupper to be fully submersed. For optimum performance and longevity, it is best to keep clean water in the reservoir at all times.

MOTOR INFORMATION

WARNING



For your own safety, **NEVER** start the motor until you fully understand the electrical requirements and standards of your machine and jobsite. When starting the saw, the operator should stand outside the path of the blade. Read requirements and features of this saw.

Your MK-1080 Paver Saw requires minimum preparation prior to operation. It is advisable, however, to periodically lubricate those metal components that pivot and rotate and observe three critical areas of concern:

NOTICE

- Ensure the proper/recommended Diamond Blade has been selected for the job.
- Inspect and ensure the proper electrical power is available for your motor.
- Ensure a constant flow of water is generated to the Diamond Blade.

The MK-1080 Paver Saw has not been engineered nor designed to cut materials (ie. steel, wood, etc.) other than those comprised of ceramic/masonry material such as clay, stone, rock, cinder and masonry brick and block. For best results, **USE ONLY MK DIAMOND BLADES**. For assistance in Diamond Blade selection, contact your distributor or MK Diamond at **(800) 262-1575**.

NOTICE

The electric motors used on the MK-1080 have been designed to deliver exceptional power over a long period of time, with virtually no maintenance requirements. However, if they do **NOT** receive the proper voltage conditions, their performance and longevity will degrade. Continued operations utilizing dubious power sourcing could damage your electric motor. If extension cords are necessary, pay particular attention to their length and gauge. Always be cautious around your jobsite power source!

THERMAL OVERLOAD PROTECTION

The Thermal Overload manual reset switch is located on the top housing of the electrical motor (Figure 24). If an extreme internal temperature is sensed, the switch will “trip” and the motor will shut off automatically. If this occurs, turn the motor “ON/OFF” switch to the “OFF” position and allow the motor to cool for at least ten minutes before restarting. Push the “reset” button (using minimal force) and resume operations.



(A)

Thermal Overload Switch

NOTICE

Interruption of motor operation caused by the thermal switch indicates the existence of improper or insufficient power to your electric motor. **DOUBLE CHECK YOUR POWER SOURCE!**

CUTTING OPERATIONS

The MK-1080 Paver Saw permits the operator several options for cutting relative to the design of the saw. The Cutting Head may be adjusted to a fixed position for “FORCED” cutting (the action of pushing the material steadily into the blade). The material may also be “STEP” cut (the process of passing the material while adjusting the blade to various depths as a means to incrementally cut the piece). Lastly, the “CHOPPING” action of the saw can be employed to expeditiously “come down onto” and “push through” the material in one motion to fully utilize the mechanics of the recoil spring /rolling conveyor cart. Whatever the preferred technique, please follow these general guidelines:

1. Hold the material firmly against the conveyor cart backstop. Use the rip guide provided to support and orient the material.
2. **DO NOT** force the material into the blade! Allow the diamonds to do the grinding.
3. When using a brand new diamond blade, make the first few cuts slowly until the blade is “broken-in” and cuts freely and easily.
4. After continuous cutting of very hard and dense materials, the blade’s cutting efficiency may slow down. Should this occur, it can be sharpened by making several passes against very abrasive material such as: soft cinder block or lightweight sandstone. **ENSURE PLENTY OF WATER IS USED DURING THIS PROCESS!**



WARNING

DO NOT operate saw without the blade guard in place. The exposed area of the blade should never exceed 180 degrees during operation. When installing the blade, ensure that the blade and flanges are free of sediment, so the fit between flange and blade is even and true.



NOTICE

A Diamond Blade actually grinds...it does not cut. Not allowing the blade to perform the way it was engineered may result in premature blade wear, diamond “glazing”, steel core warpage, or severe segment damage.

CLEANING & LUBRICATION

The slurry and cutting residue generated by the MK-1080 Paver Saw is considerable. A cleaning and lubrication schedule must be maintained in order to ensure long and trouble-free operation. As a common sensible and preventative maintenance practice, clean the dirt and cutting deposits from your machine after each use. A pressurized spray system may be used, however, never spray around the electric motor, switch box, or ON/OFF switches. Further, the following lubrication points are advised:

- Place light machine oil where friction, pivoting or rotation occurs between the structural components.
DO NOT OIL THE MOTOR!
- Pump clean/fresh water for one minute through the Blade Guard Water Tubes to safeguard against a build up of sediment and the possibility of clogging.
- Rotate the entire Cutting Head Assembly on the Pivot Shaft and lubricate where the casting and shaft make contact.

ADJUSTING BELT TENSION

Remove Blade. Refer to the “Installing the Blade” section.

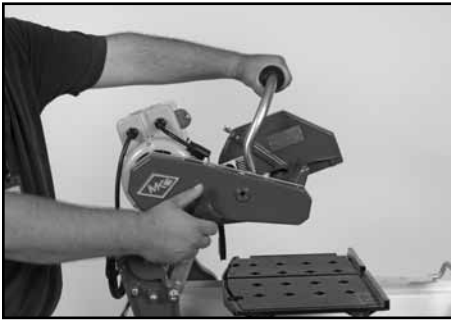

(A)

While holding the Cutting Head Handle down to counteract spring tension, loosen the Cutting Head Lock Screw and allow the Cutting Head to gently raise to its highest point.

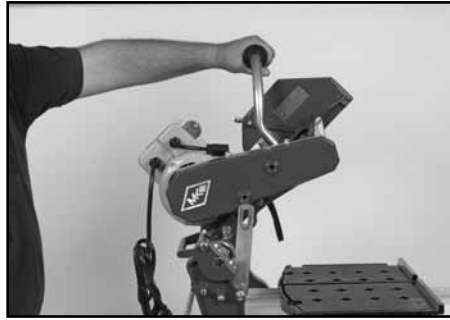

(B)

While still holding the Cutting Head Handle, remove the Cutting Head Lock Screw and raise the Cutting Head until the spring tension is released.

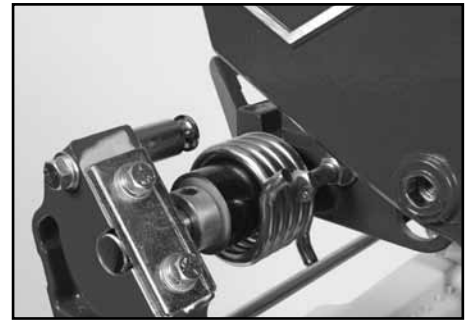

(C)

Move Spring until it is disengaged from Bolt on Cutting Head and Holder on Post.



(D)

Lower Cutting Head onto suitable wooden block.

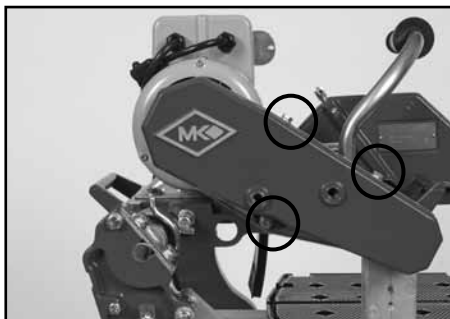

(E)

Remove 3 screws that hold Outer Belt Guard.



(F)

Remove Belt Guard.



(G)

Loosen the two front nuts securing Motor to Cutting Head.

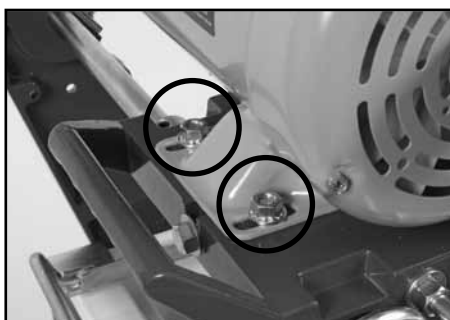

(H)

Loosen the two back nuts.



(I)

Tighten belt by turning tensioning bolt clockwise or loosen by turning counterclockwise.

ADJUSTING BELT TENSION CONTINUED

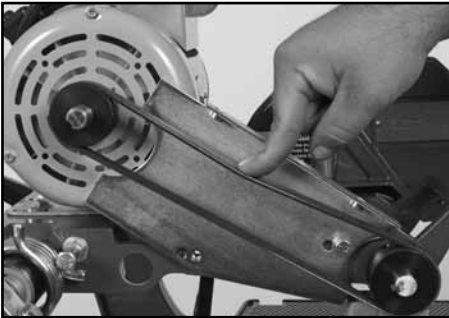

(J)

Check Belt tension by pressing on Belt with one finger midspan between the Pulleys. Belt should deflect 1/8"-1/4" under medium pressure with one finger.



(K)

Once tension is correct, replace outer Belt Guard.

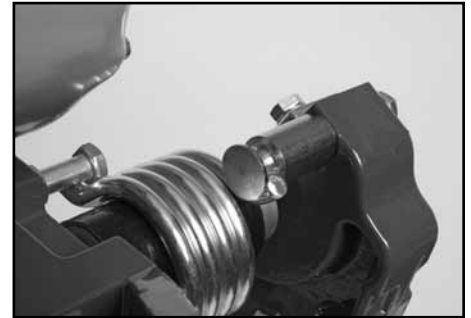

(L)

Position Spring on Post.

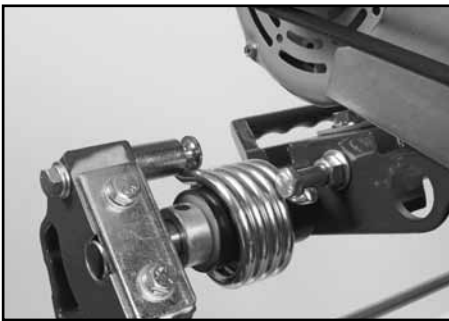

(M)

Lift Cutting Head off block and position spring so that it catches bolt on Cutting Head and holder on post.



(N)

Push Cutting Head down and position Cutting Head Locking Arm.

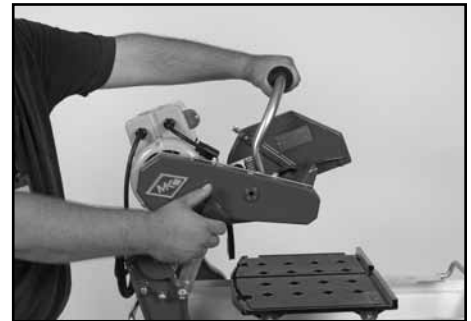

(O)

Replace Cutting Head Lock Screw.

 **NOTICE**

- **NEVER** make adjustments to belts or pulleys while the motor is plugged into a power source or is operating.

 **NOTICE**

Damage may occur to the Belts or Blade Shaft Bearings if the Belts are overtensioned. Belts that are too loose will slip resulting in a loss of power transference. Belt should deflect 1/8"-1/4" under medium pressure with one finger. Also, ensure that the Belts and Pulleys are aligned parallel relative to a steel straight edge held against the outside of the Blade Shaft Pulley.

ADJUSTING BLADE ALIGNMENT TO TABLE

(A)

Remove spring tension on Cutting Head by following in “Adjusting Belt Tension” section.



(B)

Loosen set Screw Collars on both sides of Cutting Head.



(C)

Ensure that Table is riding correctly on both Frame Rails.

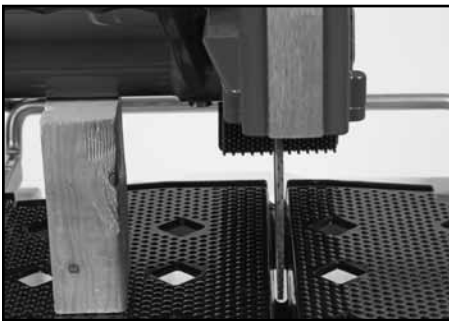

(D)

Slide Cutting Head left and right on Pivot Bar until Blade falls in middle of slot on Table (may have to temporarily replace Blade by following steps in “Installing the Blade” section).



(E)

Tighten Set Screw Collars on both sides of Cutting Head.



(F)

Retension Cutting Head by following steps in “Adjusting Belt Tension” section.

DIAMOND BLADE SHARPENING (RE-DRESSING)

Like most cutting instruments, a Diamond Blade cuts best when it is sharp!

When material being cut is matched with the proper Diamond Blade, it should yield swift and accurate cuts, and maintain an optimum operational life. **NO TWO MATERIALS CUT ALIKE.** Occasions may arise where a percentage of the diamonds on the blade edge and periphery smooth “glaze” over and the cutting efficiency is reduced. Additionally, this condition may cause the blade to “wander” or bend in the cut, giving the illusion of an “out-of-alignment” condition. If you experience any lack of cutting efficiency or effectiveness, sharpen your diamond blade by making several cuts into very abrasive material, such as simple cinder block or soft sandstone. Ensure that plenty of water is used to clean cut and cool blade.

PAVER SAW, MK-1080, 1.5 HP 120V 60HZ, 153203

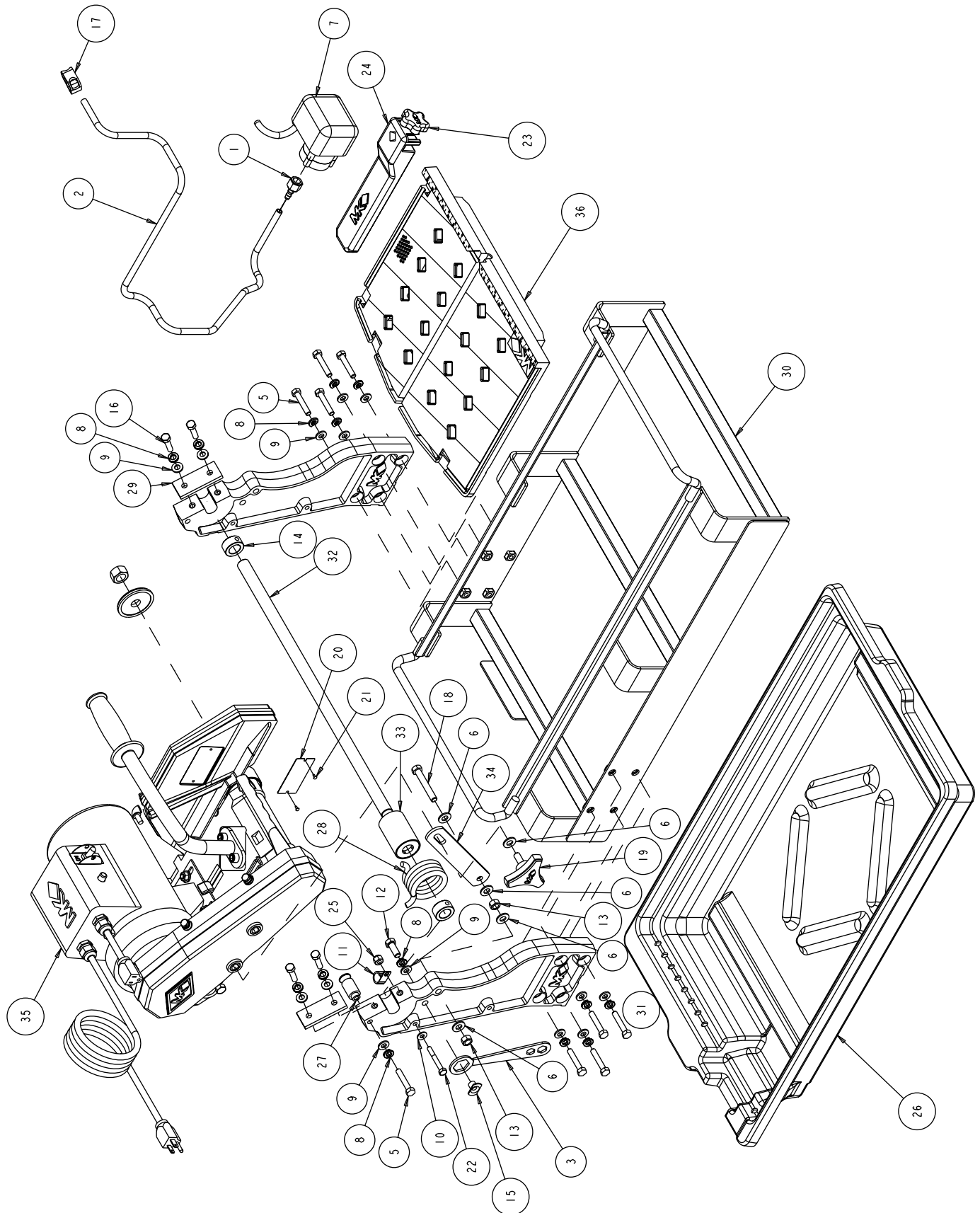

PAVER SAW, MK-1080, 1.5 HP 120V 60HZ, 153203

ITEM NO.	DESCRIPTION	PART OR IDENTIFYING NO.	QTY. REQ.
1	FITTING, PLASTIC, 1/4 FNPT X 1/4 BARB	128397	1
2	HOSE, VINYL, 3/8 X 1/4	132951	1
3	WRENCH	134684	1
5	SCREW, 5/16-18 X 1-3/4 HEX HEAD CAP	150919	9
6	WASHER, 3/8 SAE FLAT	150923	5
7	PUMP, WATER, G-150A	151271	1
8	WASHER, LOCK, SPLIT, 5/16	151747	14
9	WASHER, SAE FLAT, 5/16	151754	14
10	WASHER, 1/4 SAE FLAT	151915	1
11	CLAMP, 1/2 CUSHION LOCK	152471	1
12	SCREW, HEX HEAD CAP, 3/8-16 X 1	152507	1
13	NUT, 3/8-16 HEX CENTERLOCK	153522	2
14	COLLAR, 3/4" I.D.	153814	2
15	NUT, WELD, SLAB, 3/8-16	153945	1
16	SCREW, 5/16-18 X 1-1/4 HEX HEAD MACHINE	153950	4
17	CLAMP, HOSE, 1/2-3/4	154394	1
18	BOLT, 3/8-16 X 2-1/2 HEX HEAD TAP	155589	1
19	KNOB, TRI	156770-01	1
20	TAG, SERIAL #, BLANK	157500-RW	1
21	DRIVE SCREW, #7 X 5/16 ROUND HEAD	157849	2
22	SCREW, HEX HEAD 1/4-20 X 1-1/4	158282	1
23	KNOB, 1/4-20 X 3/4	159428-1	1
24	RIP GUIDE, LARGE DIE CAST (COMP)	159751	1
25	NUT, 1/4-20 NYLOK	159857	1
26	PAN, WATER	160041	1
27	STUD, SPRING RETAINING	160066	1
28	SPRING, TORSION, 50 DEG	160069	1
29	BRACKET, PIVOT SHAFT	160070	2
30	WELDMENT, FRAME	166865	1
31	CASTING POST (COMP)	166871	2
32	SHAFT, PIVOT	166873	1
33	ASSY, SPRING BUSHING	166874	1
34	BRACKET, HEIGHT ADJUSTMENT	166875	2
35	ASSY, CUTTING HEAD	166877	1
36	ASSY, TABLE	166880	1

PAVER SAW, MK-1080 HOME DEPOT, 1.5 HP 120V 60HZ, 153203-HD

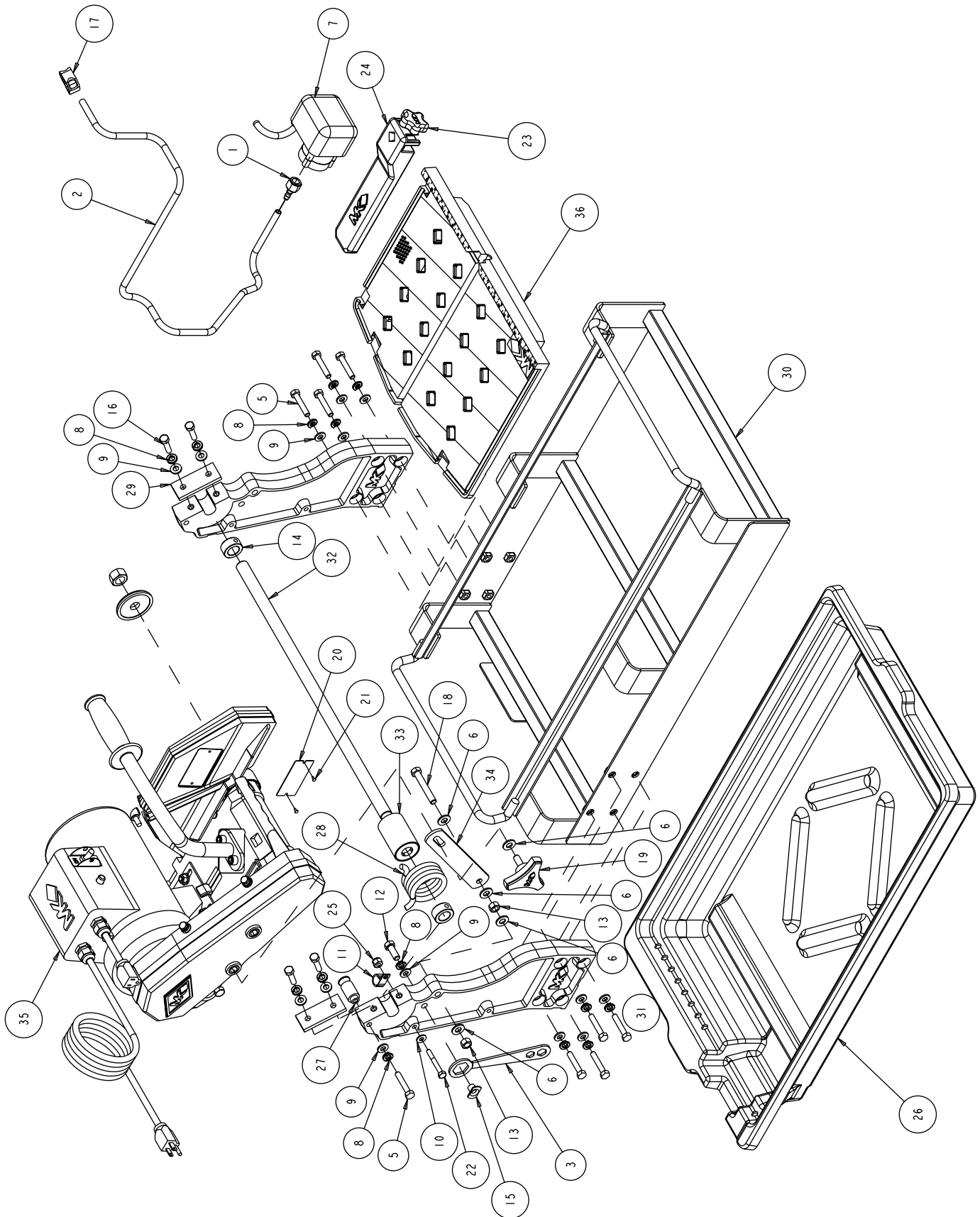

PAVER SAW, MK-1080 HOME DEPOT, 1.5 HP 120V 60HZ, 153203-HD

ITEM NO.	DESCRIPTION	PART OR IDENTIFYING NO.	QTY. REQ.
1	FITTING, PLASTIC, 1/4 FNPT X 1/4 BARB	128397	1
2	HOSE, VINYL, 3/8 X 1/4	132951	1
3	WRENCH	134684	1
5	SCREW, 5/16-18 X 1-3/4 HEX HEAD CAP	150919	9
6	WASHER, 3/8 SAE FLAT	150923	5
7	PUMP, WATER, G-150A	151271	1
8	WASHER, LOCK, SPLIT, 5/16	151747	14
9	WASHER, SAE FLAT, 5/16	151754	14
10	WASHER, 1/4 SAE FLAT	151915	1
11	CLAMP, 1/2 CUSHION LOCK	152471	1
12	SCREW, HEX HEAD CAP, 3/8-16 X 1	152507	1
13	NUT, 3/8-16 HEX CENTERLOCK	153522	2
14	COLLAR, 3/4" I.D.	153814	2
15	NUT, WELD, SLAB, 3/8-16	153945	1
16	SCREW, 5/16-18 X 1-1/4 HEX HEAD MACHINE	153950	4
17	CLAMP, HOSE, 1/2-3/4	154394	1
18	BOLT, 3/8-16 X 2-1/2 HEX HEAD TAP	155589	1
19	KNOB, TRI	156770-01	1
20	TAG, SERIAL #, BLANK	157500-RW	1
21	DRIVE SCREW, #7 X 5/16 ROUND HEAD	157849	2
22	SCREW, HEX HEAD 1/4-20 X 1-1/4	158282	1
23	KNOB, 1/4-20 X 3/4	159428-1	1
24	RIP GUIDE, LARGE DIE CAST (COMP)	159751	1
25	NUT, 1/4-20 NYLOK	159857	1
26	PAN, WATER	160041	1
27	STUD, SPRING RETAINING	160066	1
28	SPRING, TORSION, 50 DEG	160069	1
29	BRACKET, PIVOT SHAFT	160070	2
30	WELDMENT, FRAME	166865	1
31	CASTING POST (COMP)	166871-HD	2
32	SHAFT, PIVOT	166873	1
33	ASSY, SPRING BUSHING	166874	1
34	BRACKET, HEIGHT ADJUSTMENT	166875	2
35	ASSY, CUTTING HEAD	166877-HD	1
36	ASSY, TABLE	166880	1

PAVER SAW, MK-1080 ASSY, CUTTING HEAD, 166877

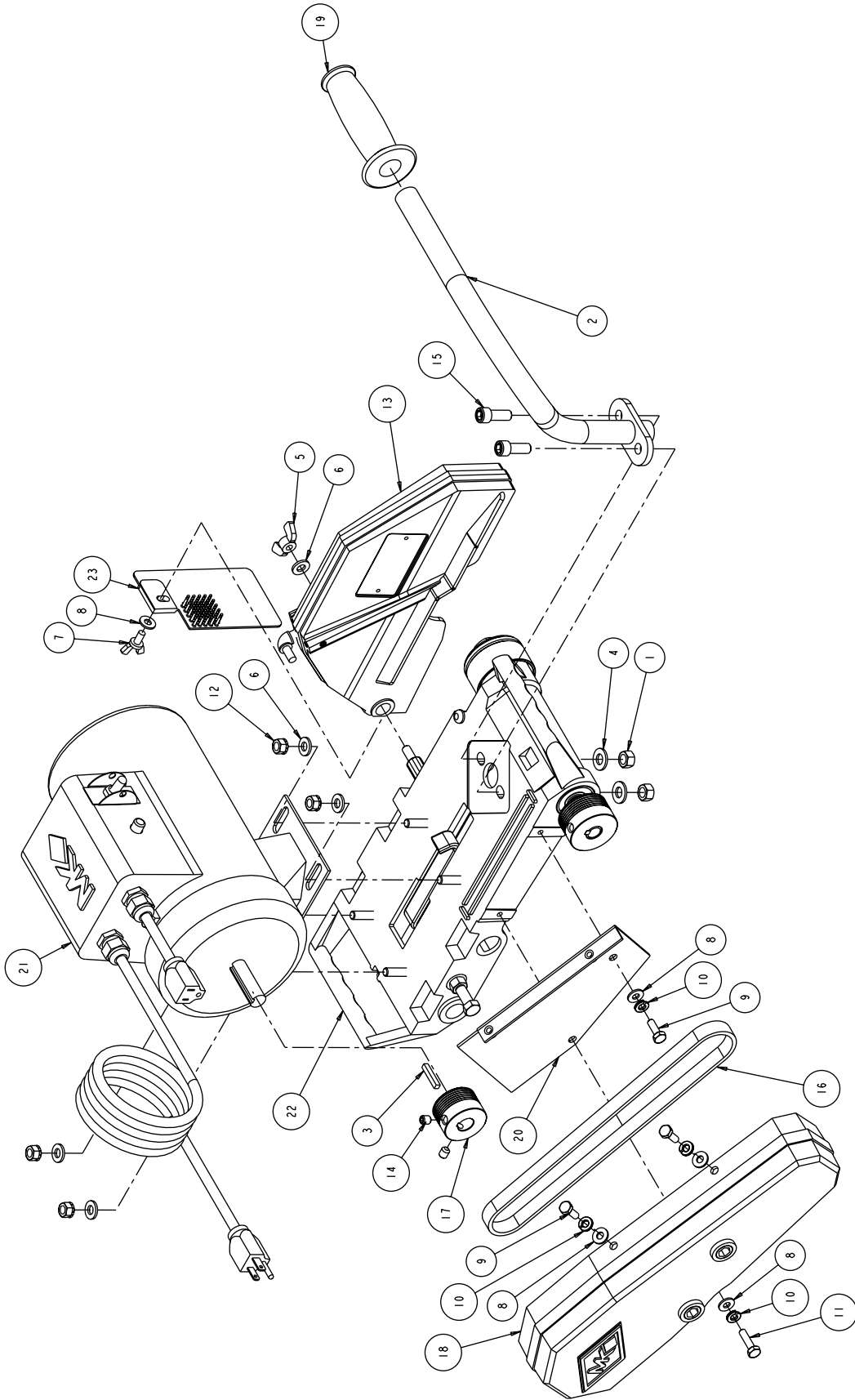

PAVER SAW, MK-1080 ASSY, CUTTING HEAD, 166877

ITEM NO.	DESCRIPTION	PART OR IDENTIFYING NO.	QTY. REQ.
1	NUT, 3/8-16 HEX	101188	2
2	HANDLE, BRICKSAW	139931	1
3	KEY, 3/16 SQ X 1-1/8	150344	1
4	WASHER, 3/8 SAE FLAT	150923	2
5	WINGNUT, 5/16-18 NYLOK	151746	1
6	WASHER, 5/16 SAE FLAT	151754	5
7	SCREW, WING, 1/4-20 X 1/2	151888	1
8	WASHER, 1/4 SAE FLAT	151915	5
9	SCREW, 1/4-20 X 3/4 HEX HEAD MACHINE	152370	3
10	WASHER, 1/4 SPLIT LOCK	152591	4
11	SCREW, HEX HD CAP, 1/4-20 X 1	152676	1
12	NUT, HEX, TW, 5/16-18	153942	4
13	ASSY, BLADE GUARD	154297	1
14	SCREW, 5/16-18 X 3/8 SOCKET HEAD SET	157083	2
15	SCREW, SOCKET HEAD CAP, 3/8-16 X 1	157529	2
16	BELT, MCIRO-V, 260J6	158194	1
17	PULLEY, 6J17 X 5/8 BORE	158214	1
18	GUARD, BELT (COMP)	158319-15	1
19	GRIP, HANDLE, 7/8 ID	158608	1
20	BRACKET, INNER BELTGUARD	158611	1
21	MOTOR, 115V, 1-1/2 HP	160127	1
22	ASSY, MOTOR MOUNT	166878	1
23	GUARD, SPLASH, MODIFIED	167172	1

PAVER SAW, MK-1080 HOME DEPOT ASSY, CUTTING HEAD, 166877-HD

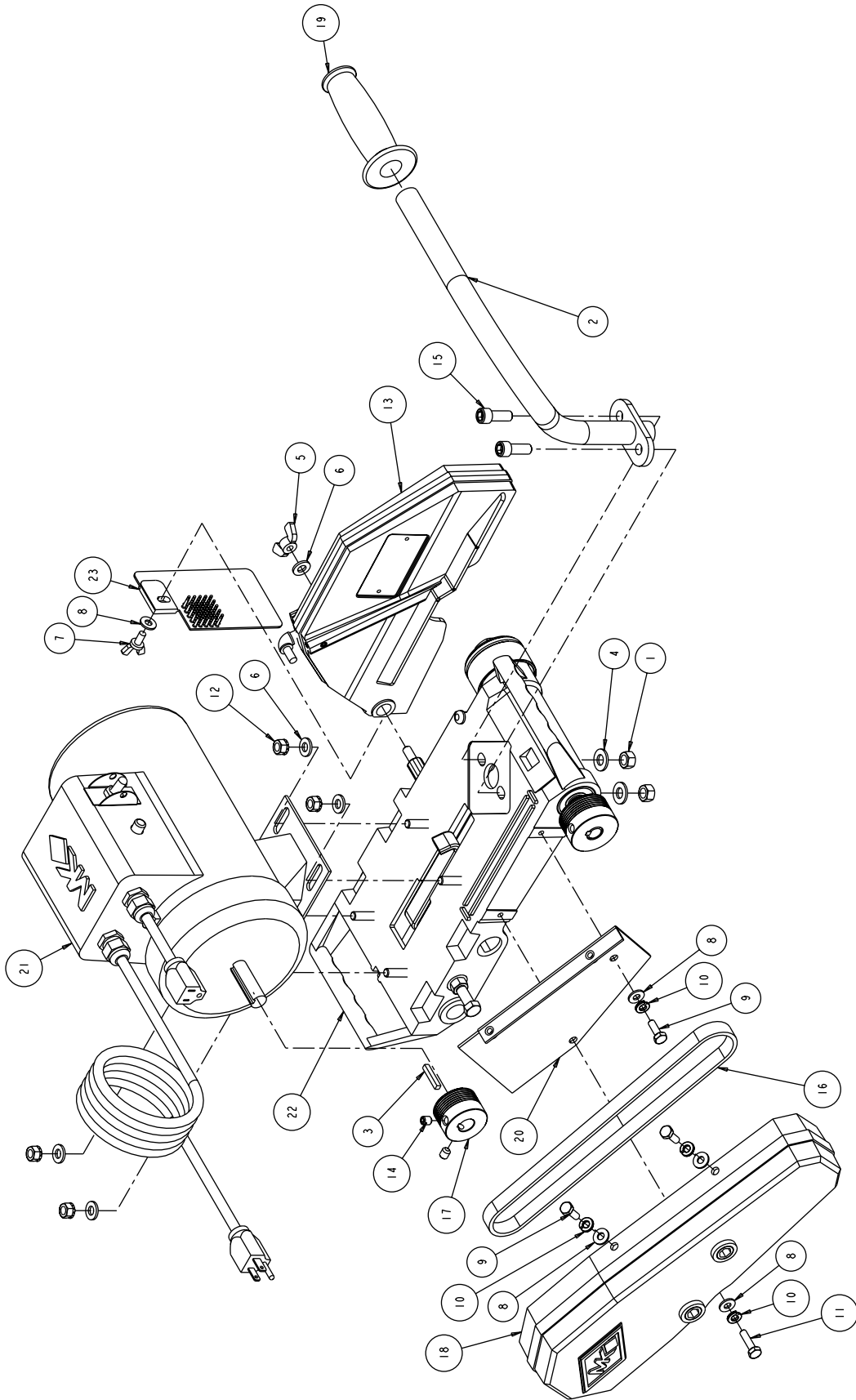

PAVER SAW, MK-1080 HOME DEPOT ASSY, CUTTING HEAD, 166877-HD

ITEM NO.	DESCRIPTION	PART OR IDENTIFYING NO.	QTY. REQ.
1	NUT, 3/8-16 HEX	101188	2
2	HANDLE, BRICKSAW	139931	1
3	KEY, 3/16 SQ X 1-1/8	150344	1
4	WASHER, 3/8 SAE FLAT	150923	2
5	WINGNUT, 5/16-18 NYLOK	151746	1
6	WASHER, 5/16 SAE FLAT	151754	5
7	SCREW, WING, 1/4-20 X 1/2	151888	1
8	WASHER, 1/4 SAE FLAT	151915	5
9	SCREW, 1/4-20 X 3/4 HEX HEAD MACHINE	152370	3
10	WASHER, 1/4 SPLIT LOCK	152591	4
11	SCREW, HEX HD CAP, 1/4-20 X 1	152676	1
12	NUT, HEX, TW, 5/16-18	153942	4
13	ASSY, BLADE GUARD	154297-HD	1
14	SCREW, 5/16-18 X 3/8 SOCKET HEAD SET	157083	2
15	SCREW, SOCKET HEAD CAP, 3/8-16 X 1	157529	2
16	BELT, MCIRO-V, 260J6	158194	1
17	PULLEY, 6J17 X 5/8 BORE	158214	1
18	GUARD, BELT (COMP)	158319-HD	1
19	GRIP, HANDLE, 7/8 ID	158608	1
20	BRACKET, INNER BELTGUARD	158611	1
21	MOTOR, 115V, 1-1/2 HP	160127	1
22	ASSY, MOTOR MOUNT	166878-HD	1
23	GUARD, SPLASH, MODIFIED	167172	1

PAVER SAW, MK-1080 ASSY, MOTOR MOUNT, 166878

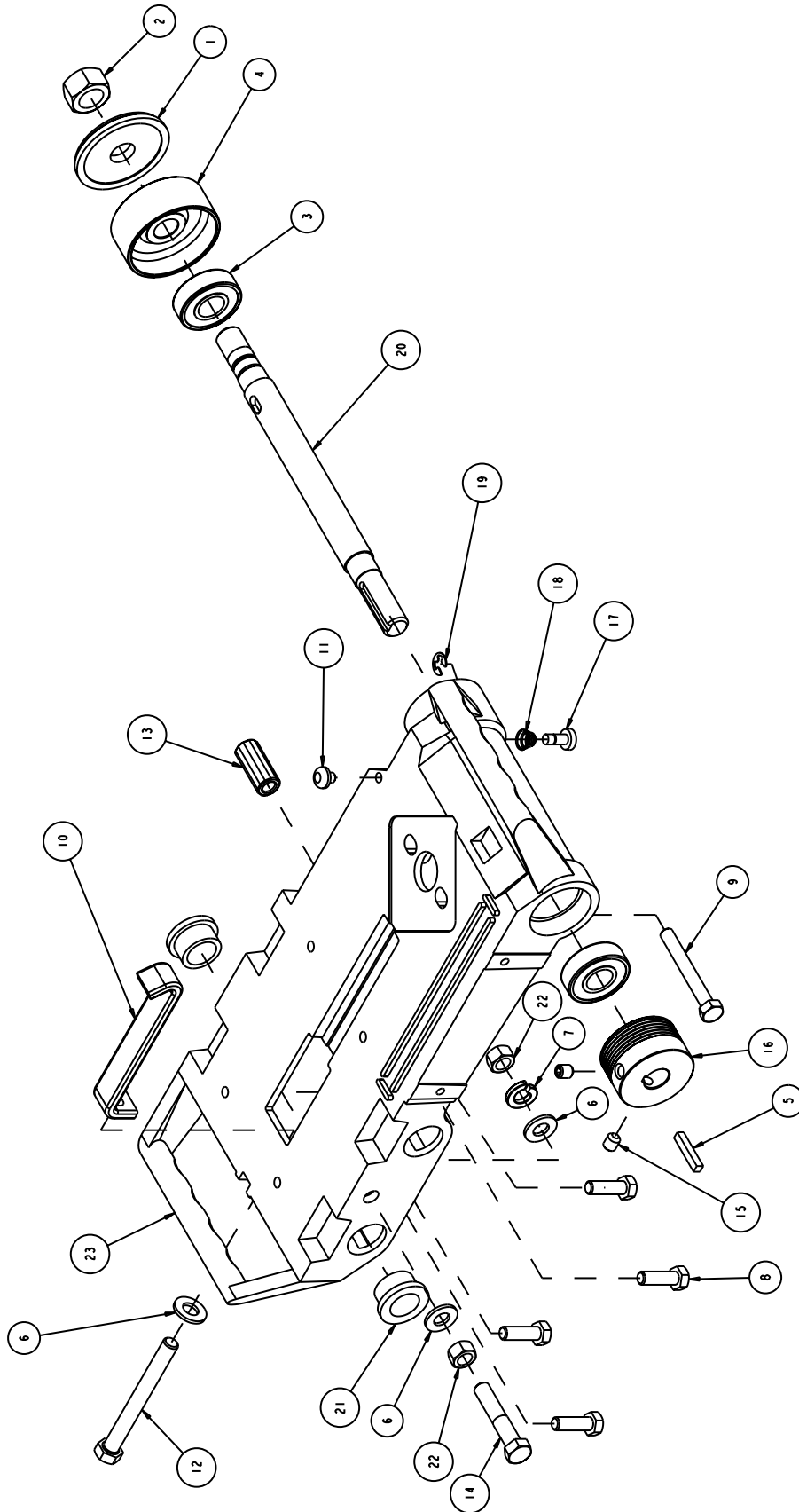

PAVER SAW, MK-1080 ASSY, MOTOR MOUNT, 166878

ITEM NO.	DESCRIPTION	PART OR IDENTIFYING NO.	QTY. REQ.
1	FLANGE, OUTER	135830	1
2	NUT, HEX, 5/16-18	135848	1
3	BEARING, BALL, 17 X 40 X 12 MM	137711	2
4	FLANGE, Ø2-3/8 INNER	137737	1
5	KEY, 3/16 SQ X 1-1/8	150344	1
6	WASHER, 3/8 SAE FLAT	150923	3
7	WASHER, 3/8 SPLIT LOCK	150925	1
8	SCREW, 5/16-18 X 1 HEX HEAD MACHINE	151743	4
9	BOLT, HEX HD TAP, 5/16-18 X 2-1/2	151748	1
10	STRAP, 1 INCH MOTOR ADJ.	152673	1
11	BUMPER, RUBBER, 1/2 DIA	152674	1
12	BOLT, 3/8-16 X 3-1/2 HEX HEAD TAP	153147	1
13	PIVOT, BLADE GUARD	153208	1
14	SCREW, HEX HD CAP, 3/8-16 X 2	153485	1
15	SCREW, 5/16-18 X 3/8 SOCKET HEAD SET	157083	2
16	PULLEY, 6J19 X 5/8 BORE	158199	1
17	BUTTON, SHAFT LOCK	158200	1
18	SPRING, BLADE SHAFT LOCK	158201	1
19	RING, 1/4 E-STYLE RETAINING	158202	1
20	SHAFT, BLADE	158222	1
21	BUSHING, 3/4 ID FLANGED	159207	2
22	NUT, 3/8-16 HEX	159863	2
23	MOUNT, MOTOR (COMP)	166879	1

PAVER SAW, MK-1080 HOME DEPOT ASSY, MOTOR MOUNT, 166878-HD

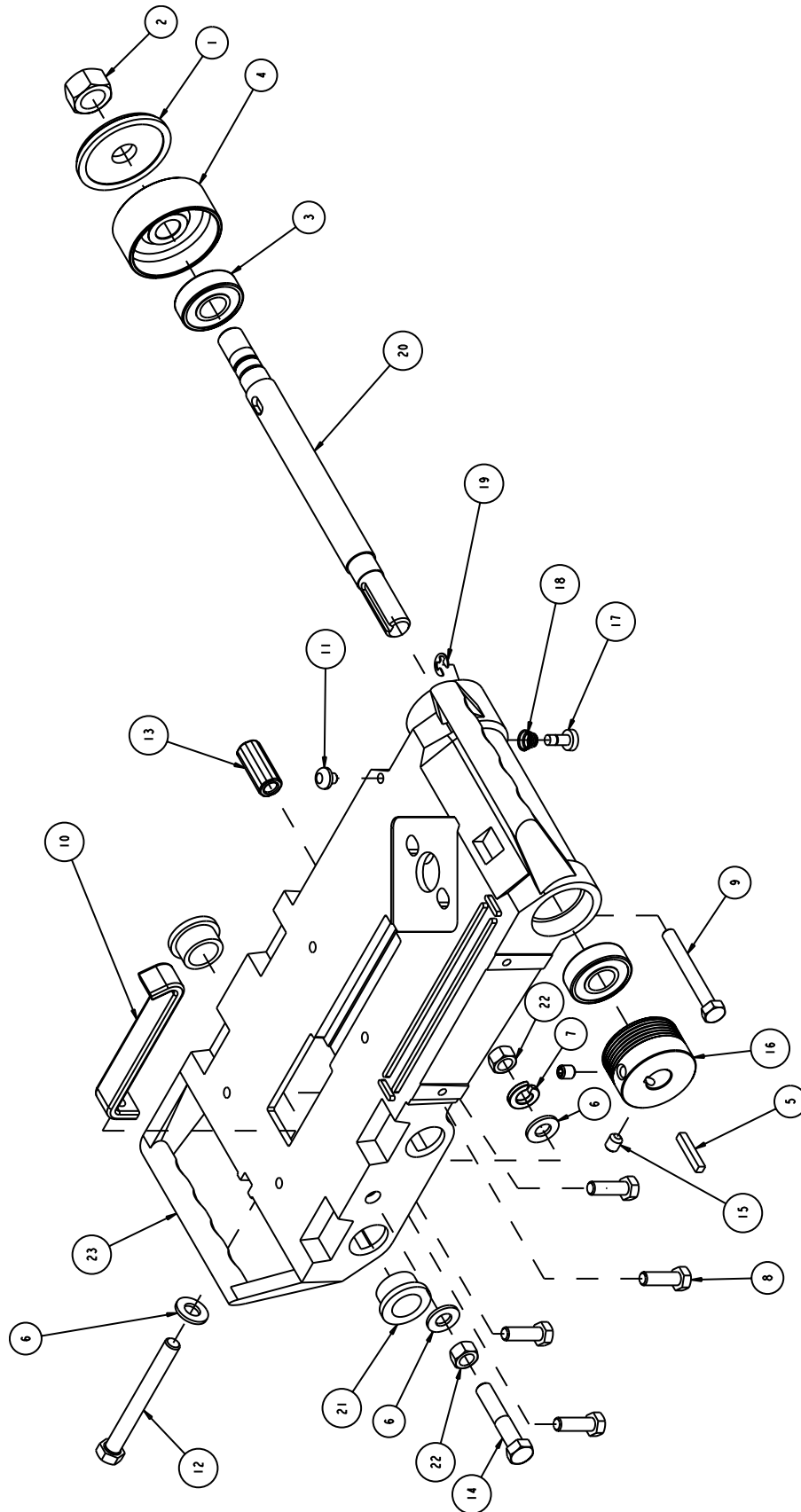

PAVER SAW, MK-1080 HOME DEPOT ASSY, MOTOR MOUNT, 166878-HD

ITEM NO.	DESCRIPTION	PART OR IDENTIFYING NO.	QTY. REQ.
1	FLANGE, OUTER	135830	1
2	NUT, HEX, 5/16-18	135848	1
3	BEARING, BALL, 17 X 40 X 12 MM	137711	2
4	FLANGE, Ø2-3/8 INNER	137737	1
5	KEY, 3/16 SQ X 1-1/8	150344	1
6	WASHER, 3/8 SAE FLAT	150923	3
7	WASHER, 3/8 SPLIT LOCK	150925	1
8	SCREW, 5/16-18 X 1 HEX HEAD MACHINE	151743	4
9	BOLT, HEX HD TAP, 5/16-18 X 2-1/2	151748	1
10	STRAP, 1 INCH MOTOR ADJ.	152673	1
11	BUMPER, RUBBER, 1/2 DIA	152674	1
12	BOLT, 3/8-16 X 3-1/2 HEX HEAD TAP	153147	1
13	PIVOT, BLADE GUARD	153208	1
14	SCREW, HEX HD CAP, 3/8-16 X 2	153485	1
15	SCREW, 5/16-18 X 3/8 SOCKET HEAD SET	157083	2
16	PULLEY, 6J19 X 5/8 BORE	158199	1
17	BUTTON, SHAFT LOCK	158200	1
18	SPRING, BLADE SHAFT LOCK	158201	1
19	RING, 1/4 E-STYLE RETAINING	158202	1
20	SHAFT, BLADE	158222	1
21	BUSHING, 3/4 ID FLANGED	159207	2
22	NUT, 3/8-16 HEX	159863	2
23	MOUNT, MOTOR (COMP)	166879-HD	1

PAVER SAW, MK-1080 ASSY, TABLE, 166880

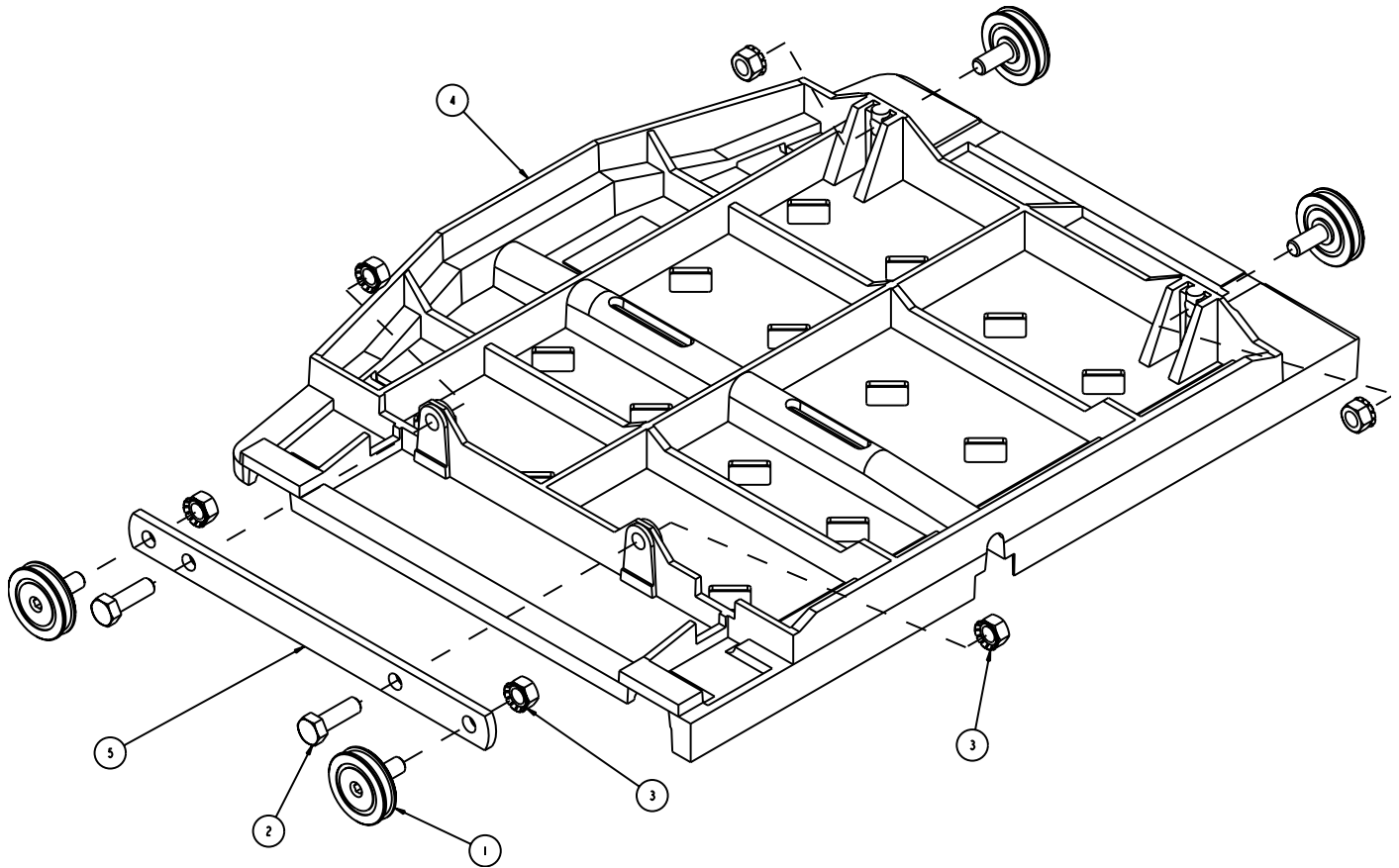

ITEM NO.	DESCRIPTION	PART OR IDENTIFYING NO.	QTY. REQ.
1	WHEEL, CONVEYOR CART	133090	4
2	SCREW, 5/16-18 X 1 HEX HEAD MACHINE	151743	2
3	NUT, HEX, TW, 5/16-18	153942	6
4	TABLE (COMP)	166881	1
5	BRACKET, TABLE WHEEL	167173	1

PAVER SAW, MK-1080 ASSY, BLADE GUARD, 154297

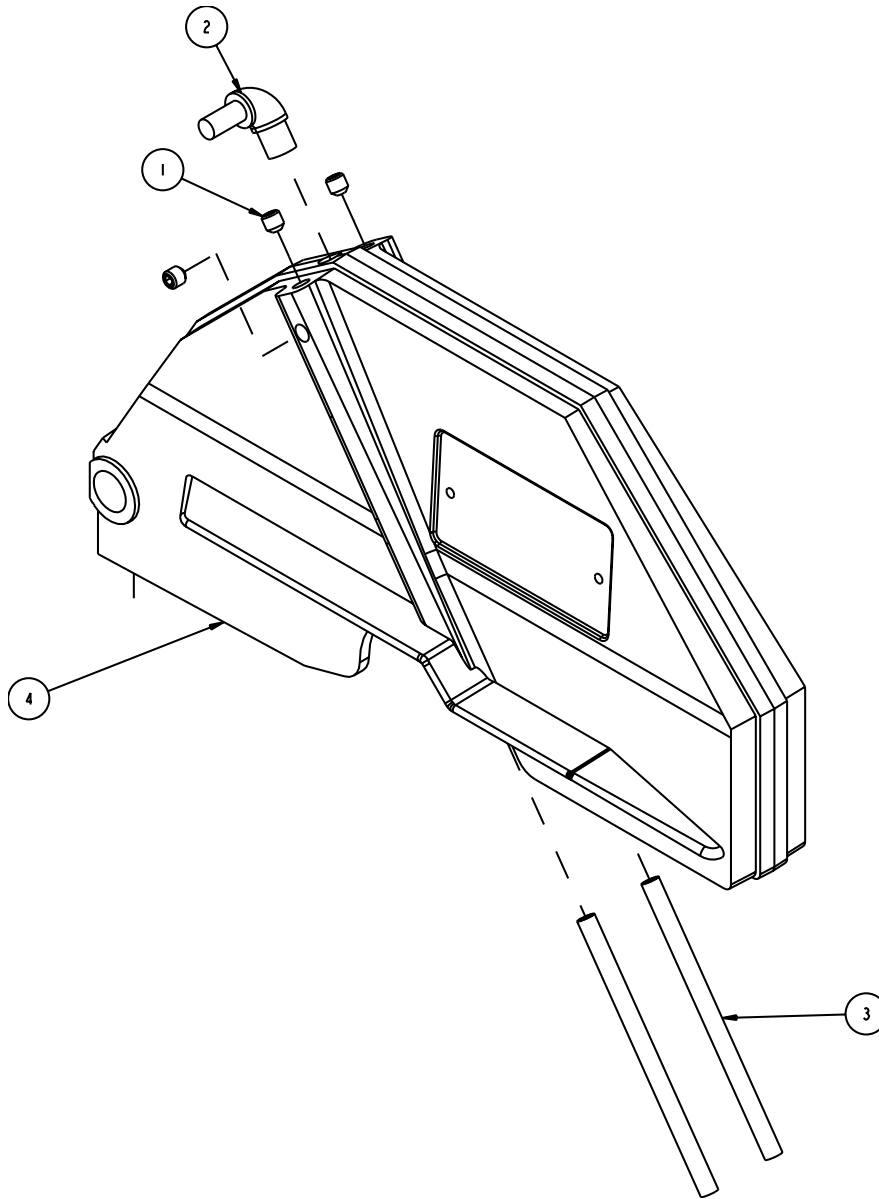

ITEM NO.	DESCRIPTION	PART OR IDENTIFYING NO.	QTY. REQ.
1	SCREW, 5/16-18 X 1/2 SOCKET HEAD SET	152607	3
2	ELBOW, 1/8 MNPT X 1/4 BARB, BRASS	154652	1
3	TUBE, WATER	155389	2
4	GUARD, BLADE (COMP)	155608	1

PAVER SAW, MK-1080 HOME DEPOT ASSY, BLADE GUARD, 154297-HD

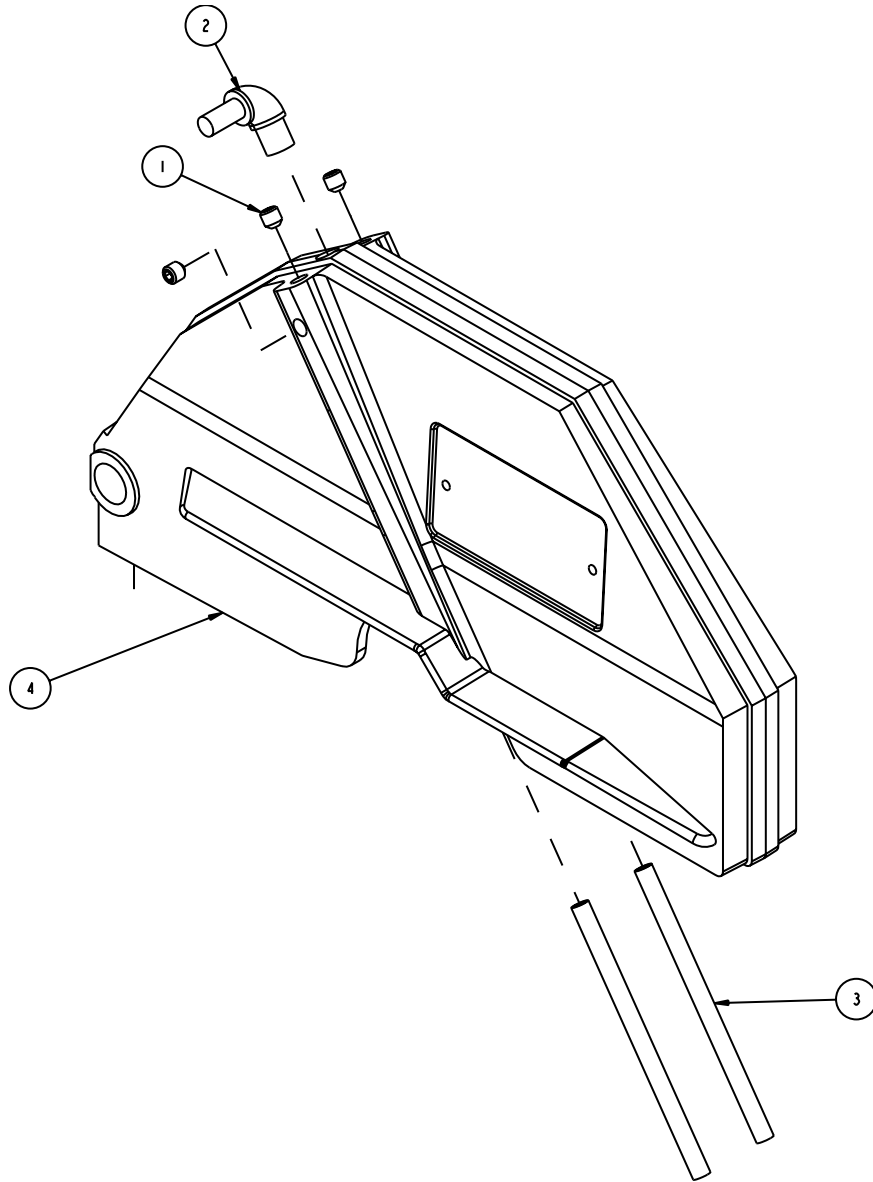

ITEM NO.	DESCRIPTION	PART OR IDENTIFYING NO.	QTY. REQ.
1	SCREW, 5/16-18 X 1/2 SOCKET HEAD SET	152607	3
2	ELBOW, 1/8 MNPT X 1/4 BARB, BRASS	154652	1
3	TUBE, WATER	155389	2
4	GUARD, BLADE (COMP)	155608-OR	1

PAVER SAW, MK-1080, ASSY, SPRING BUSHING, 166874

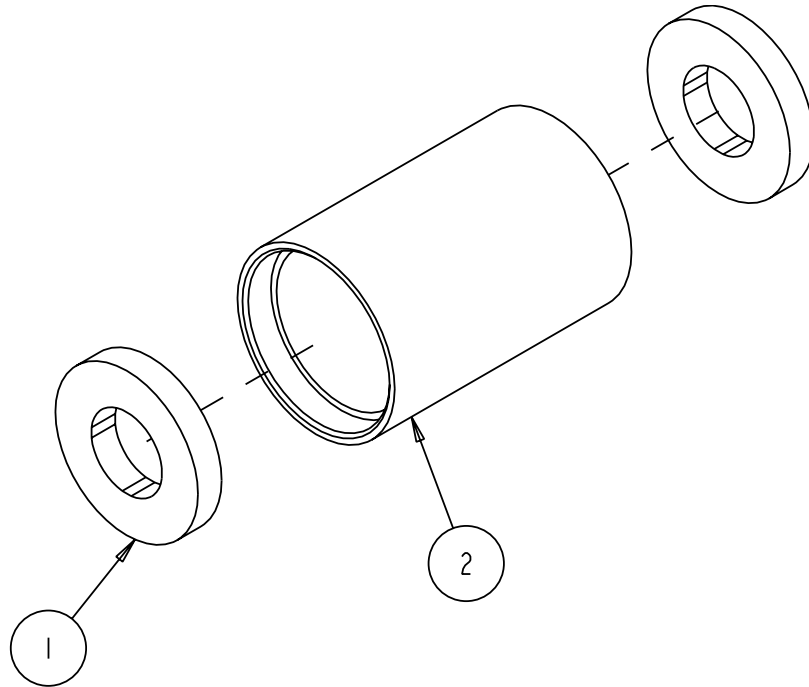

ITEM NO.	DESCRIPTION	PART OR IDENTIFYING NO.	QTY. REQ.
1	GUIDE BAR COVER	152393	2
2	BUSHING, SPRING	166876	1

ORDERING INFORMATION

You may order MK Diamond products through your local MK Diamond distributor or, you may order direct from MK Diamond.

When ordering direct from MK Diamond, please have the following information ready before calling:

- The Model Number of the saw
- The Serial Number of the saw
- Where the saw was purchased and when
- The Part Number for the part(s) being ordered
- The Part Description for the part(s) being ordered

NOTE: There is a \$25.00 minimum order when ordering direct from MK Diamond. A \$5.00 charge will be added to orders having a net billing value under \$50.00. All purchases must be made using VISA, MasterCard or American Express.

All parts may be ordered by calling toll free to – 800 421-5830 or 310 539-5221 and asking for Customer Service. For technical questions, call – 800 474-5594.

RETURN MATERIALS POLICY

To expedite the service relative to the return of a product purchased through MK Diamond, please observe the following:

NOTE: When returning all items, they must have been purchased within the previous twelve (12) months.

- Have the Model Number of the saw
- Have the Serial Number of the saw
- Have the location of where the saw was purchased
- Have the date when the saw was purchased
- Contact Customer Service for approval to return the item(s)
- Obtain a Returned Goods Number (RGA) authorizing the return
- Follow the packaging instructions in the following section
- Ensure your item(s) are prepaid to the destination

For returned items, call toll free to – 800 421-5830 or 310 539-5221 and ask for Customer Service. For technical questions, call – 800 474-5594 or 310 257-2845.

PACKAGING INSTRUCTIONS

- Remove the Cutting Head and Support Angle Assembly
- Dry the saw before shipping
- When packing, include the following: Saw, Diamond Blade, Blade Guard and Support Angle Assembly and Adjustable Cutting Guide (Other Accessories are not required)
- Package the unit in its original container or one of comparable size (do not ship the unit partially exposed)
- Ensure all parts are secured in the packaging to prevent moving

AUTHORIZED SERVICE CENTERS

For quicker repair time, you may contact MK Diamond Customer Service, toll free, at 800 421-5830 or 310 539-5221 for the Authorized Service Center closest to you or visit our web site at www.mkdiamond.com. For technical questions, call – 800 474-5594.

CONTACT:

Please contact MK Diamond Products, Inc. Customer Service Department with any questions you might have regarding distributors, parts or service.

Telephone: **(800) 421-5830**

Fax: **(310) 539-5158**

E-mail: **Customer_Service@MKDiamond.com**

Customer Service Hours: **Monday through Friday, 6AM-4PM PST**

MK Diamond Products, Inc.

1315 Storm Parkway

Torrance, CA 90501

MK DIAMOND PRODUCTS, INC. LIMITED WARRANTY

MK DIAMOND PRODUCTS, INC. will guarantee every machine they build, to be free from defects in material and workmanship for (1) one year from date of purchase. The obligation of MK DIAMOND PRODUCTS, INC. under this warranty is limited to the repair or replacement of any parts which, under normal use, prove to be defective in material or workmanship. The parts involved or the unit in question should be returned to MK DIAMOND PRODUCTS, INC. or to a point designated by us, transportation prepaid.

This warranty does not obligate us to bear the cost of labor or transportation charges in connection with replacement or repair of defective parts. Likewise, it shall NOT apply to any unit which has been subjected to misuse, neglect or accident. This warranty does NOT apply to any machine which has been repaired or altered outside our factory.

This warranty does NOT obligate MK DIAMOND PRODUCTS, INC., with respect to items not of our manufacture, such as engines, motors, hydraulics, etc., which are subject to their own guarantees and warranties.

We shall in no event be liable for consequential damages or contingent liabilities arising out of failure of any equipment or parts to operate properly.

© COPYRIGHT 2012, MK DIAMOND PRODUCTS, INC. ALL RIGHTS RESERVED.

The MK Diamond logo is a registered trademark of MK Diamond Products, Inc. and may not be used, reproduced, or altered without written permission. All other trademarks are the property of their respective owners and used with permission.

MK Diamond may have patents, patent applications, trade marks, copyrights of other intellectual property right covering this product in this document.

This manual MUST accompany the equipment at all times. This manual is considered a permanent part of the equipment and should remain with the unit if resold.

The information and specifications included in this publication were in effect at the time of approval for printing.

**MK DIAMOND 1080 PAVER SAW
OPERATION & PARTS MANUAL**



MK Diamond Products, Inc.

MK Diamond Products, Inc.
1315 Storm Parkway
Torrance, CA 90501

Toll-Free: (800) 421-5830
Phone: (310) 539-5221
Fax: (310) 539-5158
www.mkdiamond.com